

Sustainable display simulates roof top garden concept on show floor

Sustainable design took center stage at this year's **Healthcare Building Expo** at **The Commercial Construction Show**. The innovative **Eco-Friendly Focus Centerpiece** display was divided into three sections spotlighting sustainable elements used in the retail, hospitality and healthcare markets. The healthcare portion of the exhibit was designed by **RTKL** and built by **Skanska**.

The centerpiece was a mock-up of a

Key players

Exhibit design: **RTKL**
Exhibit fabricator/contractor: **Skanska**
Bench: **Streetscapes**
Water feature: **Bluworld**
Screen wall: **Parametre by 3Form**
Spun aluminum planters: **Ekitta**
Plants/Foliage: **Tropex**
Artificial turf: **Syn Lawn**
Linoleum stained concrete: **Armstrong**

Wood decking tiles: **Bison Deck Supports**
Roof cut-away layers: **Sika-Sarnafil**
Chairs and tables: **West Coast Industries**
Flooring installer: **National Flooring**
Signage: **Georgia Printco**
Painting Contractor: **CertaPro Painters**
Paint: **Sherwin Williams**





healing roof garden featuring two distinct restorative spaces for patients, their families and hospital staff as well. The first space was situated adjacent to a restaurant exhibit. In an actual hospital, the roof garden could offer overflow seating for those who choose to dine outside the cafeteria setting. A translucent water wall separated this sunny, active area from the second space — a shady section specifically designed for quiet contemplation. In both spaces, living plants and soothing sounds of cascading water demonstrated how a roof garden can provide relief from the stress of illness and the bustling hospital environment.

To help attendees better understand the structural components of a typical green roof, a cut-away of the roofing system's layers was created at one entry to the garden. Living vegetation was planted in lightweight soil, which was also

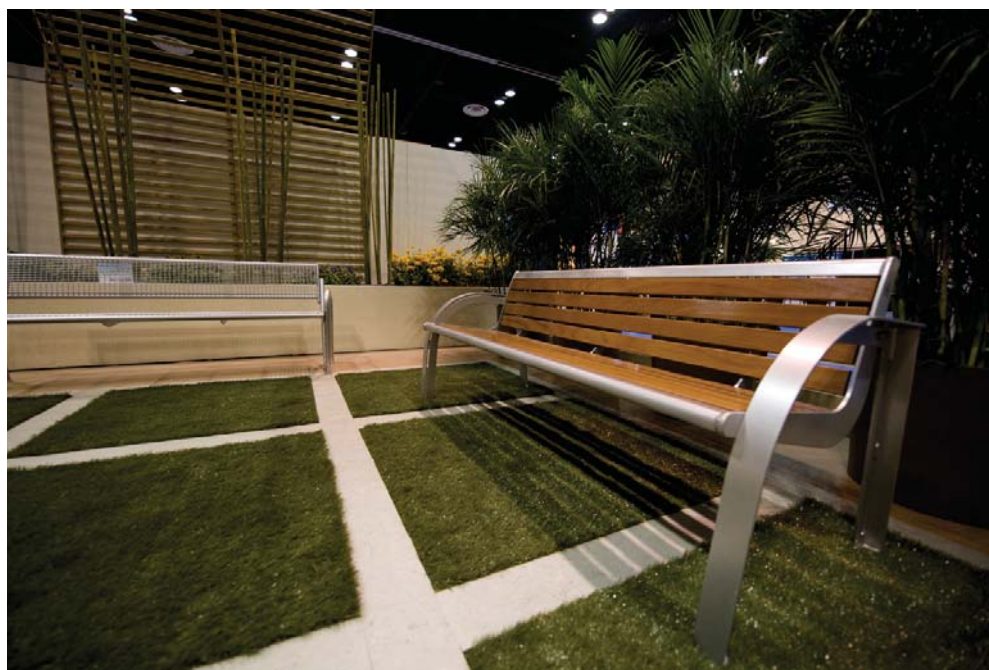

underlain by a drainage layer. Beneath that, an impermeable membrane provided a root barrier and protected the roofing membrane and the building structure.

A slightly inclined walkway, which provides wheelchair accessibility, was the central passageway to both areas of

Industry Events: Green Centerpiece

healthcare
**BUILDING
EXPO**

at the

2008
**COMMERCIAL
CONSTRUCTION
SHOW**

the garden. All the garden paths were covered in linoleum to simulate stained concrete or stone. A decorative screen created a lightweight, exterior boundary for the active garden area, and in many hospital settings that could also be used to screen the garden from unsightly mechanical equipment on the rooftop.

A wood decking system provided flooring for the garden's outdoor dining area, while grass was planted in a geometric pattern in the second, shady space. The garden featured different varieties of sedums, grasses, herbs and bamboos. Raised planters boasting native plants as well as plants with therapeutic properties surrounded the garden, including

aromatics such as rosemary and lavender. An added plus for elevated planters — they can be easily accessible to patients who are able to garden as part of their therapy. Form, texture, aroma, color and pleasant sounds were all integrated into this garden to create a restorative space that could complement any hospital's clinical care.



Green Centerpiece

