



STREETSCAPES.BIZ

Info@streetscapefurniture.com 303.398.7040



REVISIONS

	NAME	DATE	NOTES
1	---	-----	---
2	---	-----	---
3	---	-----	---
4	---	-----	---
5	---	-----	---
6	---	-----	---
7	---	-----	---
8	---	-----	---

CONFIDENTIAL INFORMATION  
THESE DRAWING, SPECIFICATIONS AND  
OTHER INFORMATION AND DOCUMENTS  
ACCOMPANYING THEM ARE THE  
CONFIDENTIAL AND PROPRIETARY PROPERTY  
OF WAUSAU TILE, INC. THE DRAWINGS  
THEMSELVES SHALL BELONG TO THE  
OWNER FOR USE ONLY ON THE PROJECT.  
ANY ADDITIONAL USE SHALL REQUIRE THE  
PRIOR WRITTEN APPROVAL OF WAUSAU TILE,  
INC. THE PROPRIETARY INFORMATION  
CONTAINED WITHIN THE DRAWINGS AND THE  
DOCUMENTS IS AND SHALL REMAIN THE  
SOLE PROPERTY OF WAUSAU TILE, INC

JOB NAME

ADDRESS  
CITY, STATE ZIP

UNLESS OTHERWISE SPECIFIED  
DIMENSIONS ARE IN INCHES  
FRACTIONS ±1/8"

DRAWN BY: TAS

DATE: 6/28/17

CO NUMBER: ?

WEIGHT: 300 LBS

PRODUCT NO.

WS4028

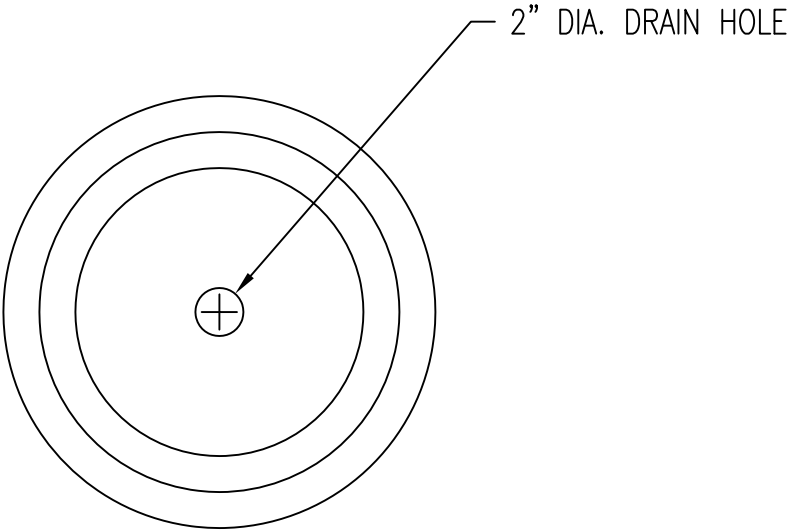

1 TOP VIEW

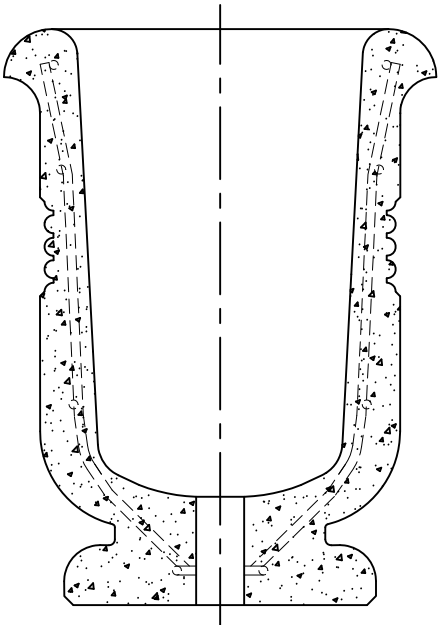

4 CROSS SECTION

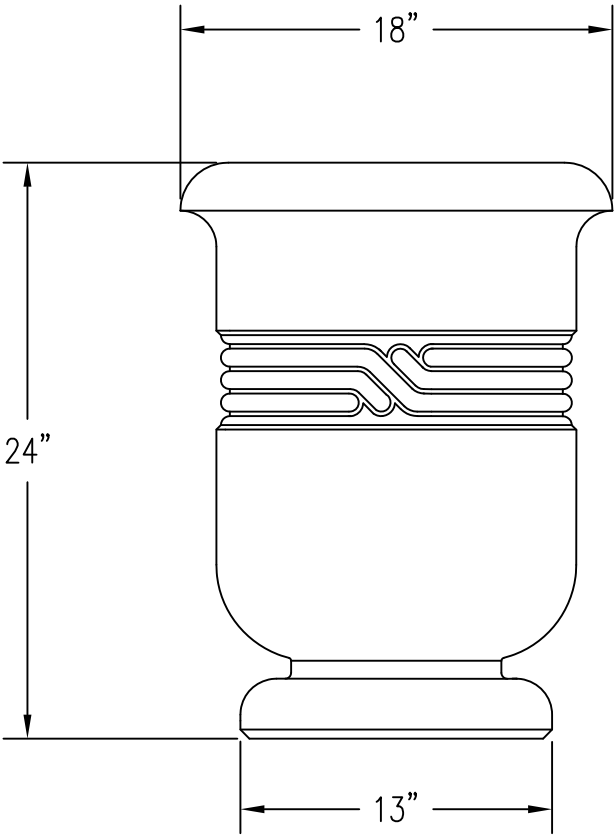

2 ELEVATION VIEW

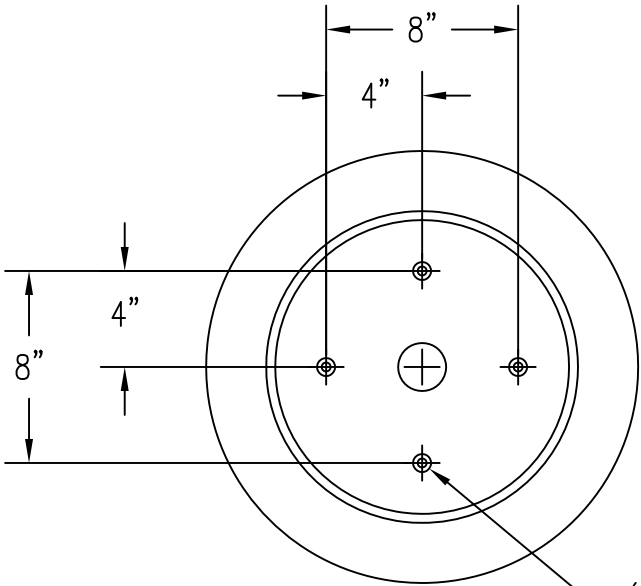

3 BOTTOM VIEW

(4)–3/8" DIA INSERTS

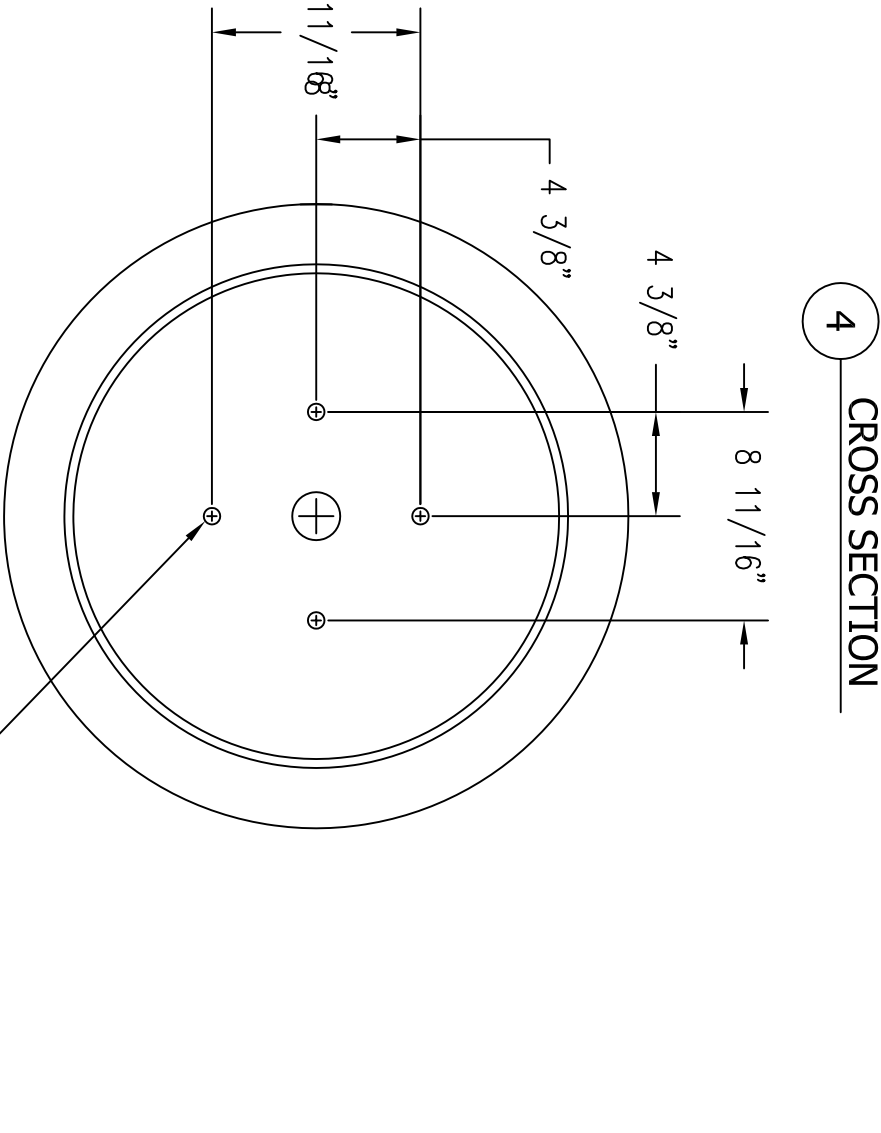
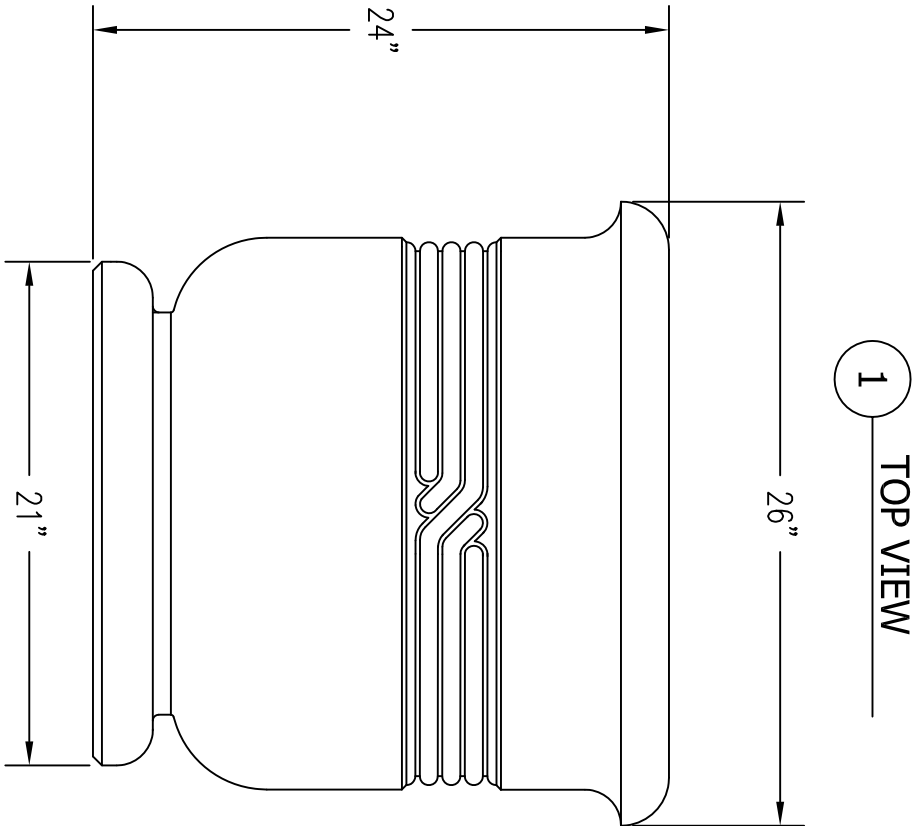
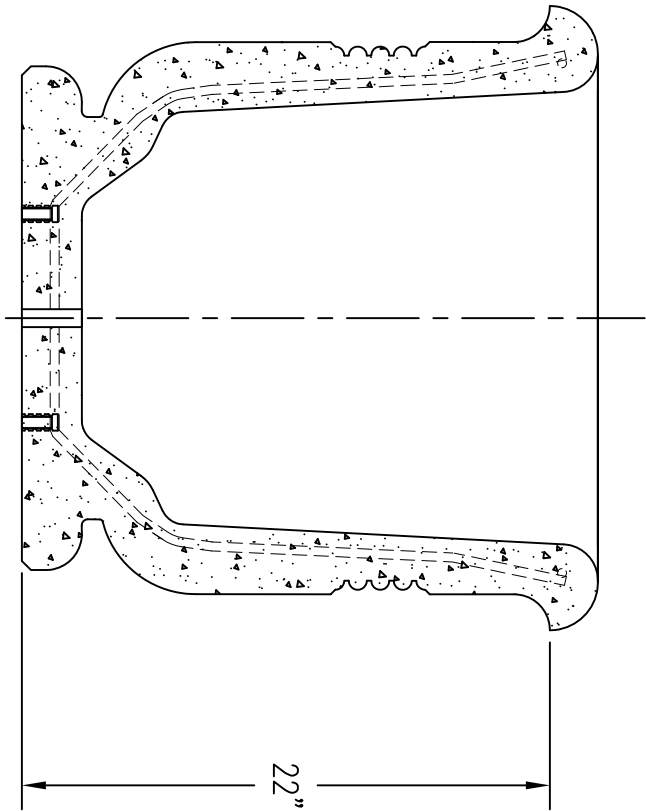
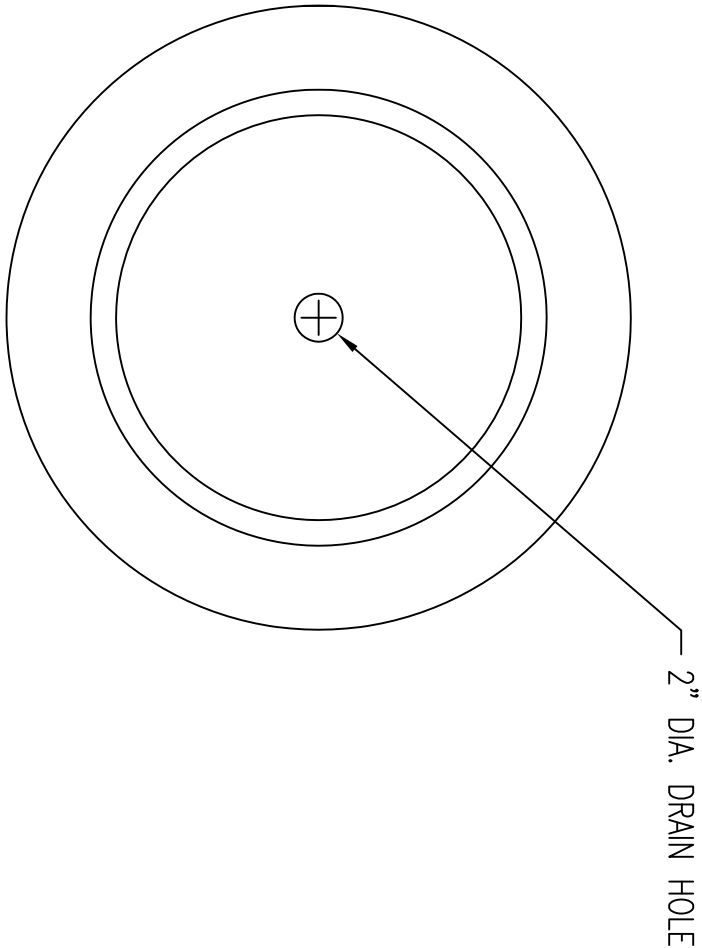

REVISIONS		
NAME	DATE	NOTES
1	---	---
2	---	---
3	---	---
4	---	---
5	---	---
6	---	---
7	---	---
8	---	---

CONFIDENTIAL INFORMATION  
THESE DRAWING, SPECIFICATIONS AND OTHER INFORMATION AND DOCUMENTS ACCOMPANYING THEM ARE THE CONFIDENTIAL AND PROPRIETARY PROPERTY OF WAUSAU TILE, INC. THE DRAWINGS THEMSELVES SHALL BELONG TO THE OWNER FOR USE ONLY ON THE PROJECT. ANY ADDITIONAL USE SHALL REQUIRE THE PRIOR WRITTEN APPROVAL OF WAUSAU TILE, INC. THE PROPRIETARY INFORMATION CONTAINED WITHIN THE DRAWINGS AND THE DOCUMENTS IS AND SHALL REMAIN THE SOLE PROPERTY OF WAUSAU TILE, INC.

JOB NAME  
ADDRESS  
CITY, STATE ZIP

UNLESS OTHERWISE SPECIFIED  
DIMENSIONS ARE IN INCHES  
FRACTIONS ±1/8"

DRAWN BY: TJS
DATE: 6/28/17
CO NUMBER: 2
WEIGHT: 430 LBS

PRODUCT NO.
WS4027

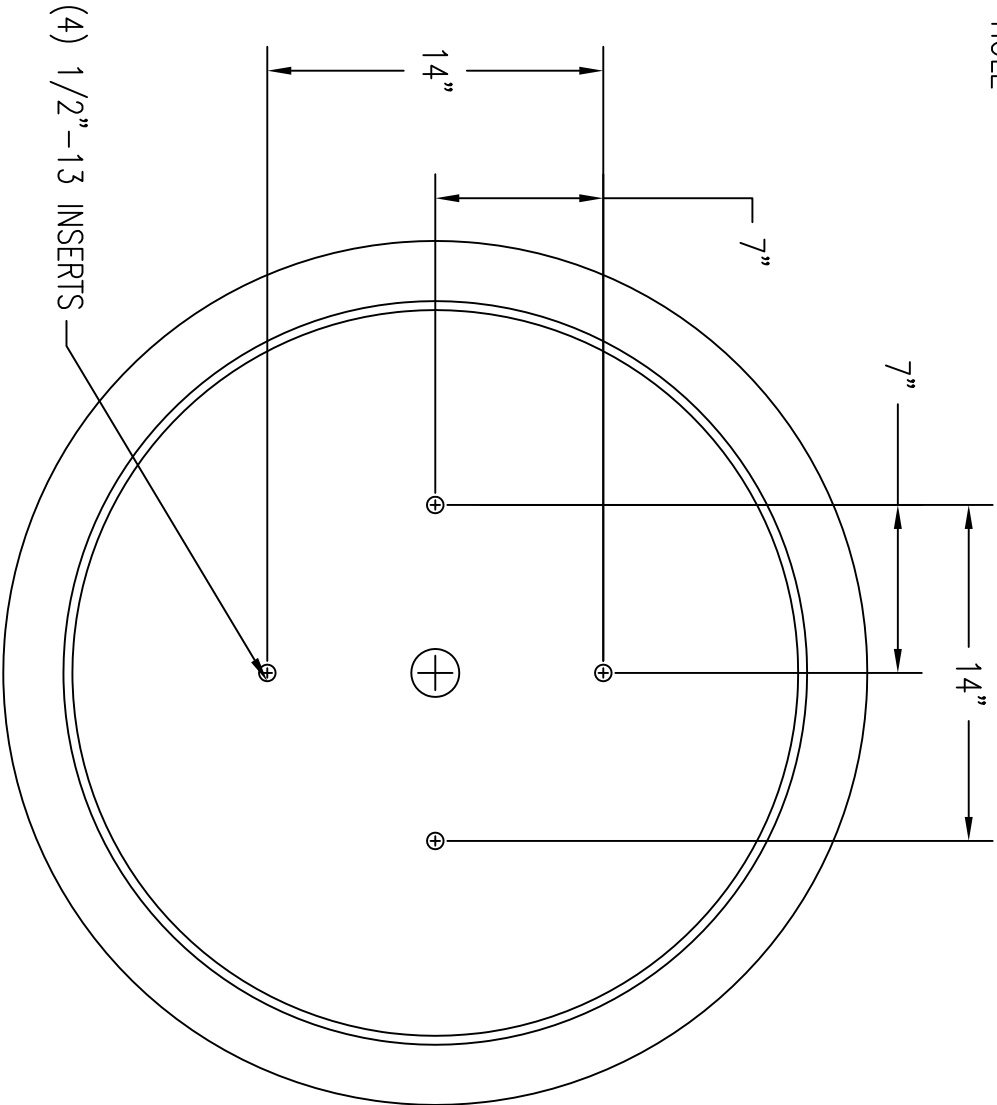
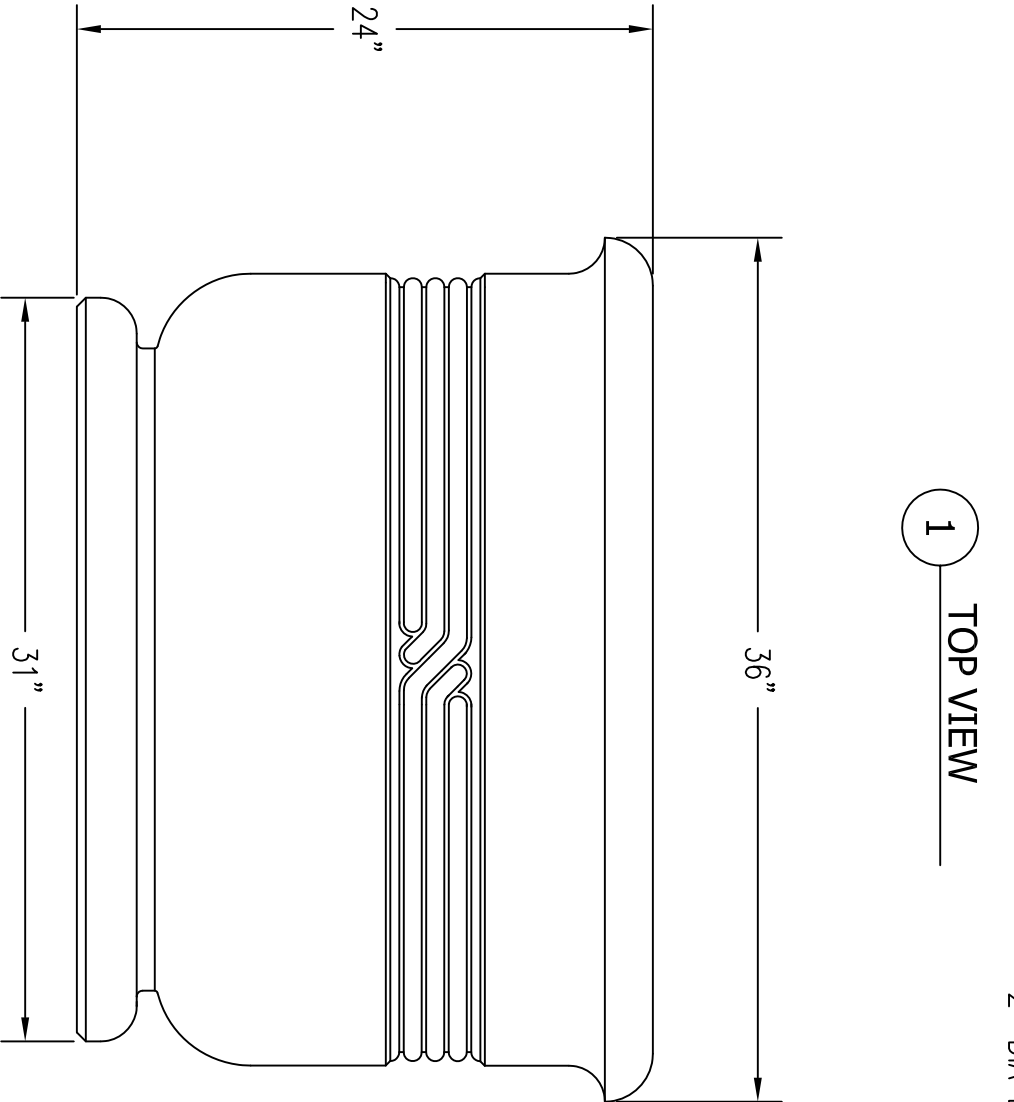
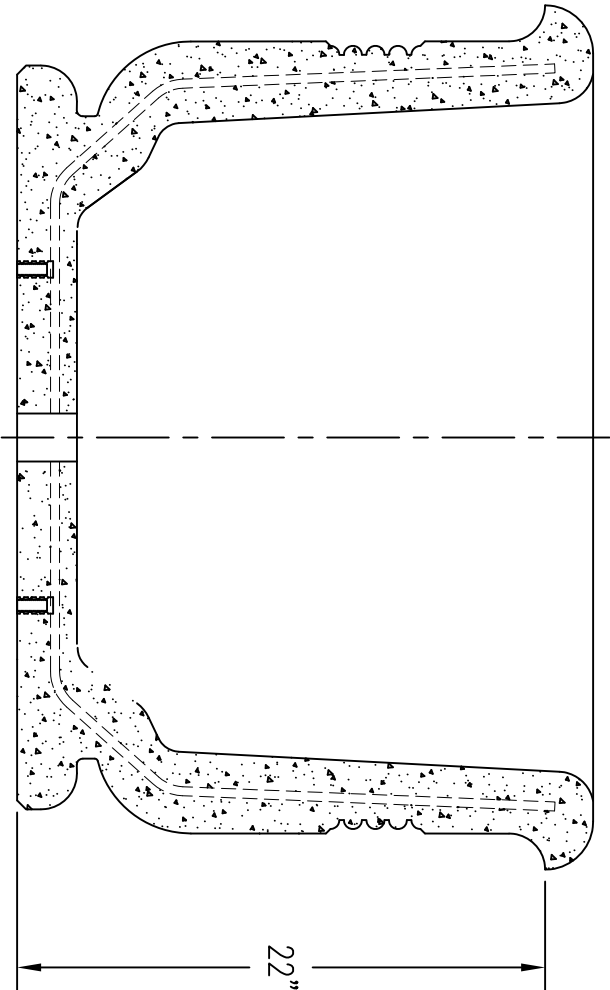
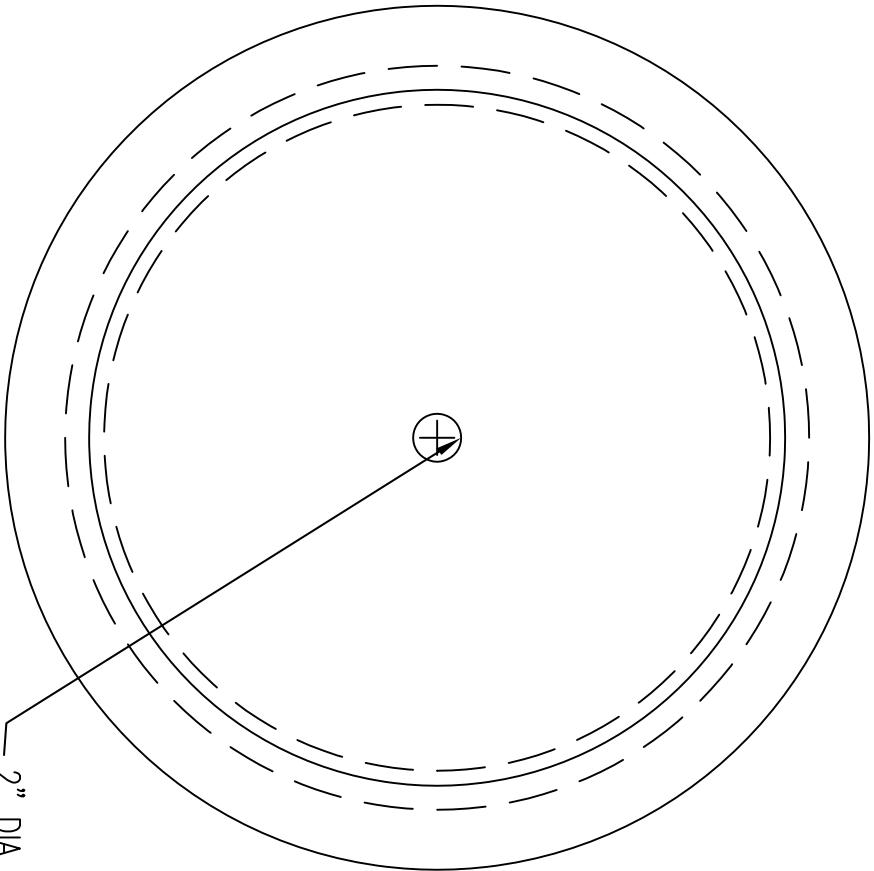

REVISIONS		
NAME	DATE	NOTES
1	---	---
2	---	---
3	---	---
4	---	---
5	---	---
6	---	---
7	---	---
8	---	---

CONFIDENTIAL INFORMATION  
THESE DRAWING, SPECIFICATIONS AND OTHER INFORMATION AND DOCUMENTS ACCOMPANYING THEM ARE THE CONFIDENTIAL AND PROPRIETARY PROPERTY OF WAUSAU TILE, INC. THE DRAWINGS THEMSELVES SHALL BELONG TO THE OWNER FOR USE ONLY ON THE PROJECT. ANY ADDITIONAL USE SHALL REQUIRE THE PRIOR WRITTEN APPROVAL OF WAUSAU TILE, INC. THE PROPRIETARY INFORMATION CONTAINED WITHIN THE DRAWINGS AND THE DOCUMENTS IS AND SHALL REMAIN THE SOLE PROPERTY OF WAUSAU TILE, INC.

JOB NAME  
ADDRESS  
CITY, STATE ZIP

UNLESS OTHERWISE SPECIFIED  
DIMENSIONS ARE IN INCHES  
FRACTIONS ±1/8"

DRAWN BY: TJS
DATE: 6/28/17
CO NUMBER: ?
WEIGHT: 675 LBS

PRODUCT NO.
WS4026