



Patent D774,422

## Form and Function

The Dero Cycle Dock™ is a solid laser cut steel plated bike rack, providing high security that is pleasing to the eye. With unassuming wheel stops at its base, the Cycle Dock™ offers three points of contact for extra bike stability, while the wide-spacing between its two arms decreases handlebar conflicts when parking two bikes. Parks two bikes.

PRODUCT & PRICING INFO CONTACT

 **STREETSCAPES**  
STREETSCAPES.BIZ

Info@streetscapefurniture.com ■ 303.398.7040





FINISH OPTIONS

Powder Coat

White	Black	Light Gray RAL 7042	Deep Red RAL 3003	Yellow RAL 1023
CNH Bright Yellow	Orange RAL 2004	Blue RAL 5005	Sky Blue RAL 5015	Hunter Green RAL 6005
Light Green RAL 6018	Green RAL 6016	Sepia Brown RAL 8014	Bronze	Silver 9007
Dark Purple	Flat Black	Wine Red RAL 3005	Beige RAL 1001	Iron Gray 7011

# Submittal Sheet

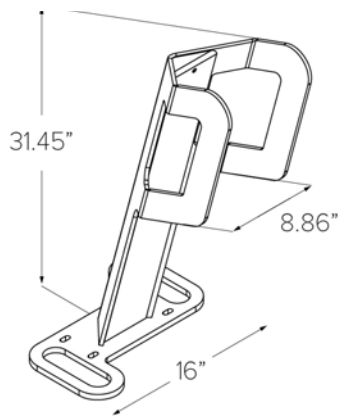

**CAPACITY** 2 Bikes

**MATERIALS** 5/8" steel plate

**FINISHES** ☐ **Powder Coat**  
Our powder coat finish assures a high level of adhesion and durability by following these steps:  
1. Sandblast  
2. Epoxy primer electrostatically applied  
3. Final thick TGIC polyester powder coat

**MOUNT OPTIONS** ☐ **Surface**  
Each Cycle Dock™ has a 5/8" steel base plate with four anchor holes for 3/8" anchors.

## SURFACE MOUNT

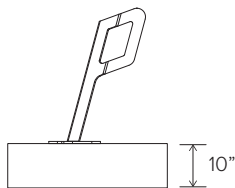
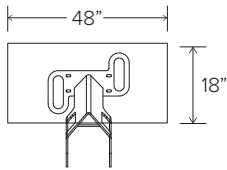

(or standard 4" sidewalk slab)

**CYCLE DOCK™**

## Setbacks

---

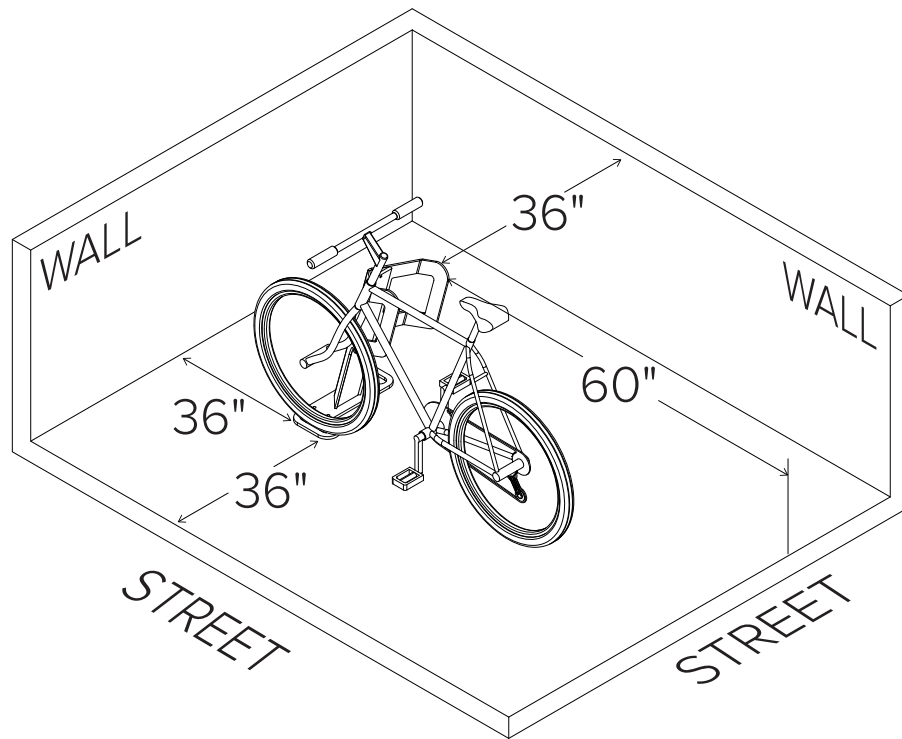

## CYCLE DOCK

# Installation Instructions

---

### TOOLS NEEDED

Tape Measure  
Marker or Pencil  
Masonry Drill Bit  
Drill (Hammer drill recommended)  
Hammer  
Wrench 9/16"  
Level

### RECOMMENDED BASE MATERIAL

Solid concrete is the best base material for installation. To ensure the proper anchors are shipped with your rack, ask your Dero Rack representative which anchor is appropriate for your application. Be sure nothing is underneath the base material that could be damaged by drilling.

1

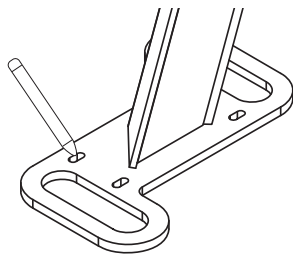

Place the rack in the desired location. Use a marker or pencil to outline the holes of the flange onto the base material.

2

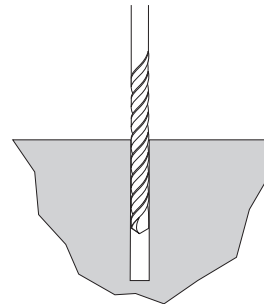

Drill 3/8" diameter holes 3" deep into surface. Make sure the holes are at least 3" away from any cracks in the base material.

3

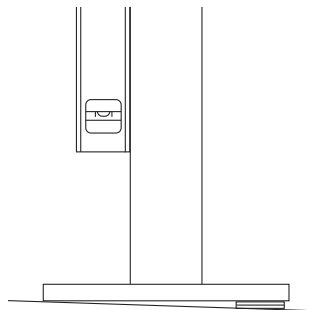

Place rack (and washers to level rack if necessary) over holes.

4

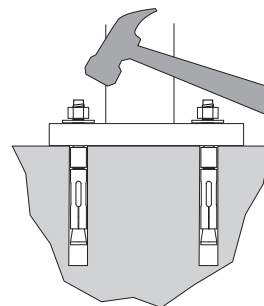

Thread nuts onto anchors, leaving approximately 1/4" of the anchor protruding, and tap into surface. Tighten nuts down to secure rack.