

Secure Bike Parking

The graceful lines and modern laser-cut design makes the Veloport™ stand out while still offering the security and durability you need in your long-term bike parking. Each bay of this modular system parks one bicycle on a lockable tray that helps guide the bike into the port.

Patent D803,762 S

PRODUCT & PRICING INFO CONTACT

 **STREETSCAPES**
STREETSCAPES.BIZ

Info@streetscapefurniture.com ■ 303.398.7040

VELOPORT™

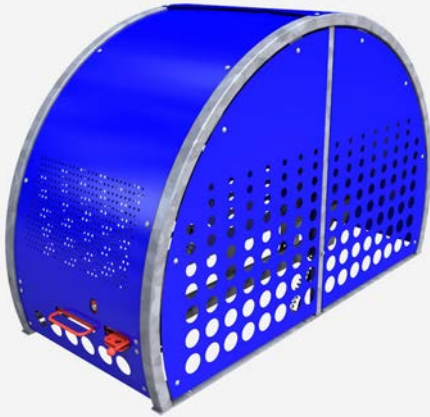

- Modular system
- U-lock/padlock handle
- Key lock option available
- Lift-assist door
- All-metal construction
- Ventilation holes for temperature control and visibility
- Number plates included in cost
- Wider fat bike trays available - contact us for this option

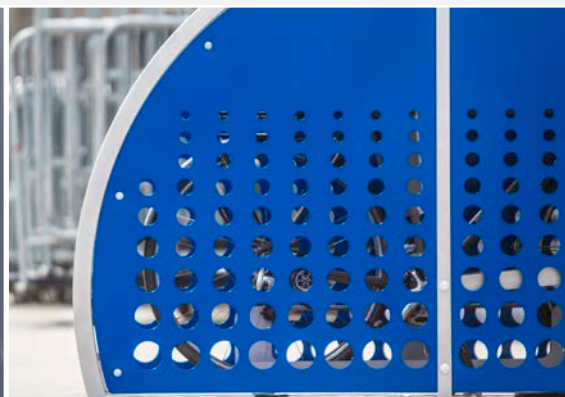
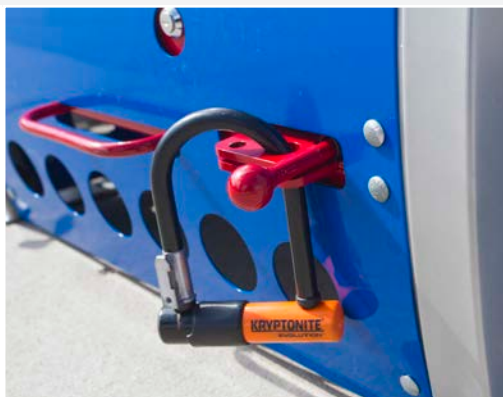

FINISH OPTIONS

Powder Coat

White	Black	Light Gray RAL 7042	Deep Red RAL 3003
Light Green RAL 6018	Orange RAL 2004	Blue RAL 5005	Sky Blue RAL 5015
Dark Purple	Green RAL 6016	Sepia Brown RAL 8014	Bronze
Wine Red RAL 3005	Beige RAL 1001	Iron Gray 7011	Hunter Green RAL 6005

MOUNT OPTIONS

Surface

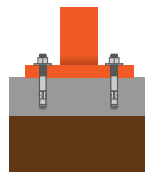

Submittal Sheet

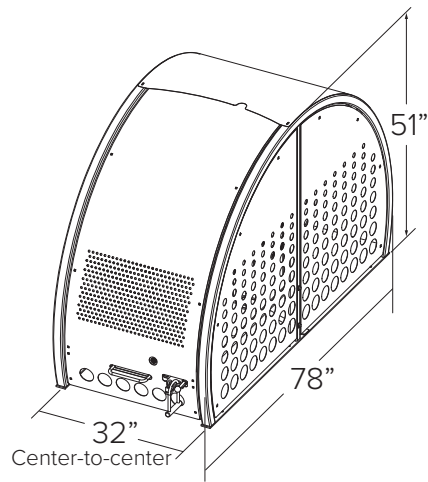

CAPACITY 1 Bike

MATERIALS Frame: 2" x 14g square tube
Back and Side Panels: 18g plate
Door: 12g aluminum plate

FINISHES

☐ **Galvanized (Frame)**
An after fabrication hot dipped galvanized finish is our standard option.

☐ **Powder Coat (Panels and Door)**
Our powder coat finish assures a high level of adhesion and durability by following these steps:
1. Sandblast
2. Epoxy primer electrostatically applied
3. Final thick TGIC polyester powder coat

MOUNT OPTIONS ☐ **Surface**

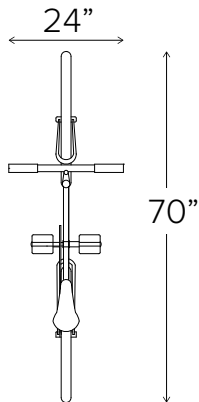

Maximum bike size

LOAD DATA

Snow load = Any amount
Wind load = 170mph, Exposure C
Seismic load = Any load

VELOPORT™
Setbacks

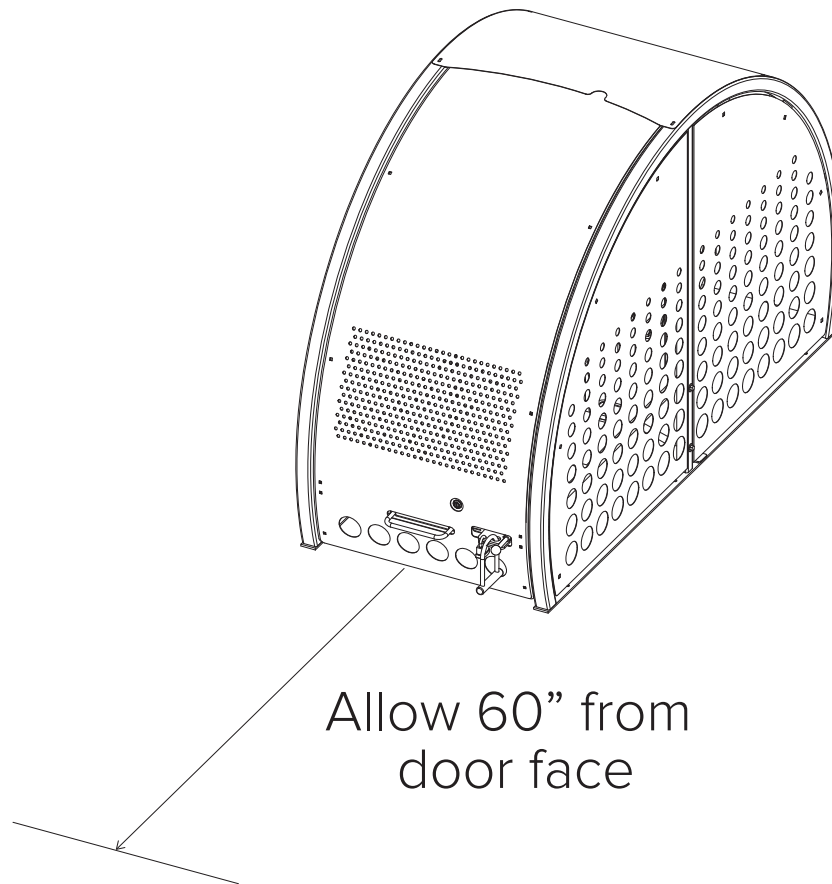

Installation Instructions

TOOLS NEEDED

Tape Measure
Marker or Pencil
Masonry Drill Bit 3/8"
Hammer Drill
Hammer
Socket Wrenches and Wrench:
9/16", 1/2", 7/16", 1/4" drive socket
wrench and 1/2" socket or
ratcheting wrench
Level
Washers (for leveling if necessary)
Drill
3/16" Allen Wrench
Pin-In-Torx Tool (Provided)

RECOMMENDED BASE MATERIAL

Solid concrete is the best base material for installation. To ensure the proper anchors are shipped with your rack, ask your Dero Rack representative which anchor is appropriate for your application. Be sure nothing is underneath the base material that could be damaged by drilling.



The install surface needs to be level or near level.

Dero recommends a maximum of 8 Veloports in each grouping.

HARDWARE LIST

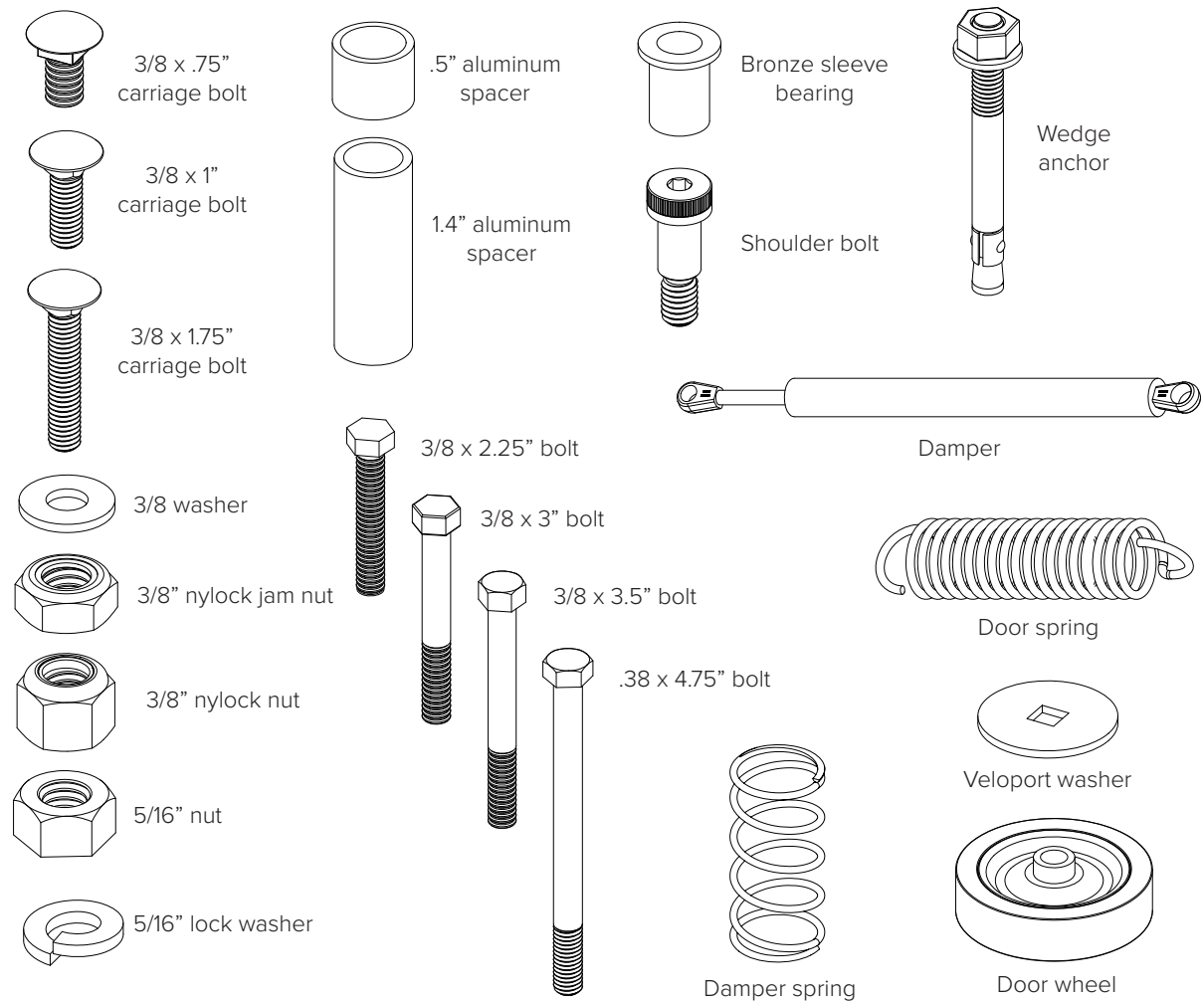

COMPONENT LIST

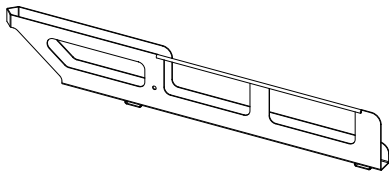

Bike tray

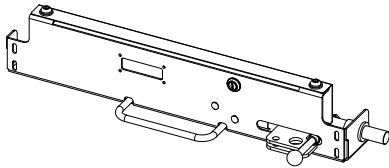

Door handle assembly

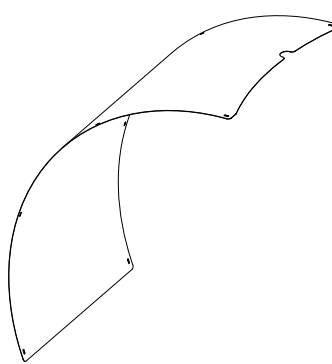

Frame panel

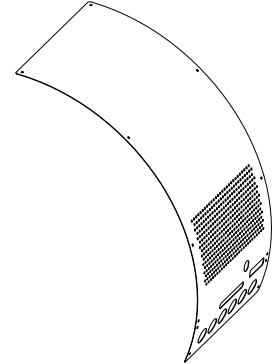

Door panel

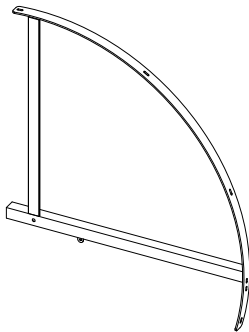

Door left frame

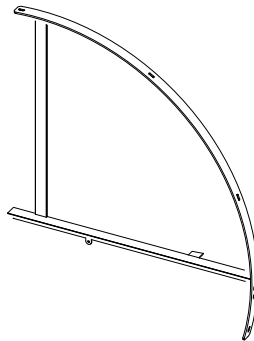

Door right frame

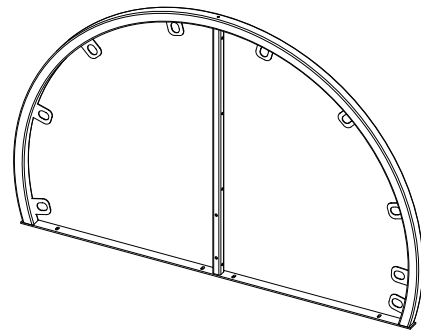

Frame

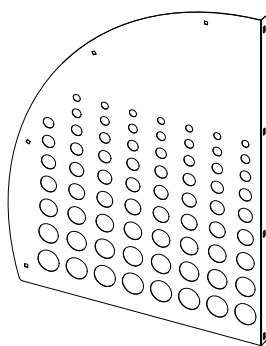

Side panel left

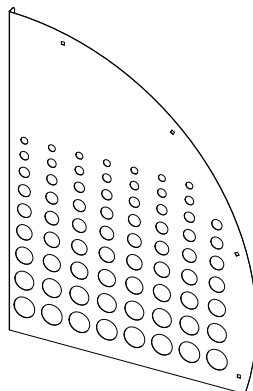

Side panel right

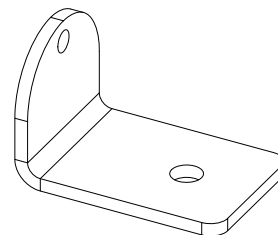

Spring flange

Installation Instructions

1

Place the frames 32" on-center with the initial frame oriented as shown. Repeat pattern as necessary. Anchor the frames at the noted anchor points. Leave at least 1" of anchor thread exposed above the frame base plate. Confirm that the front and back of the frames are 32" on-center and that the center posts are in-line and parallel. It may be necessary to use shimming washers under the frame base plate for leveling. Leave anchors finger-tight.

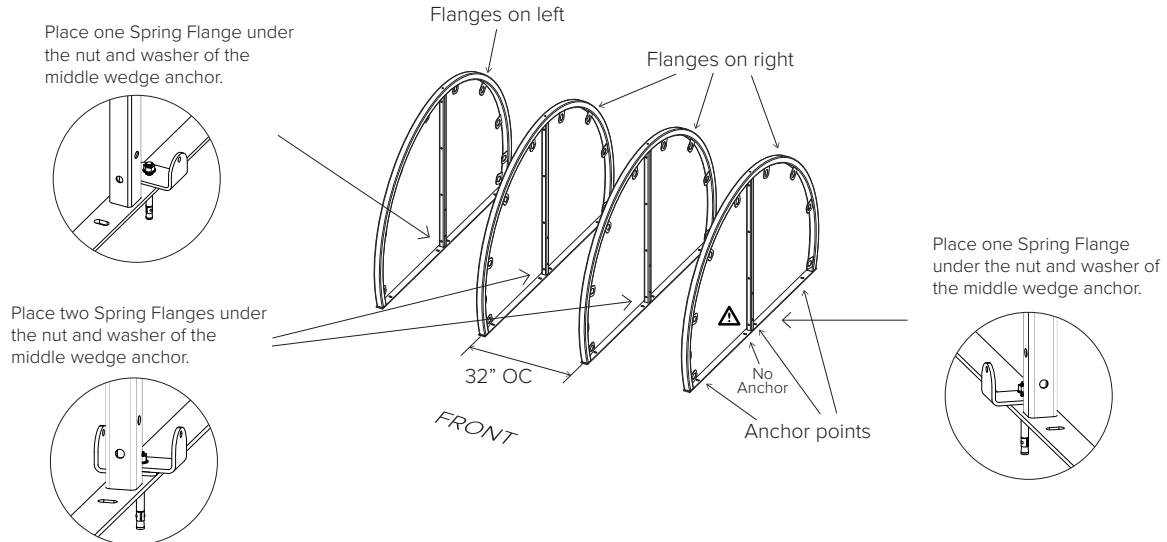

2

Attach side panels oriented as shown.

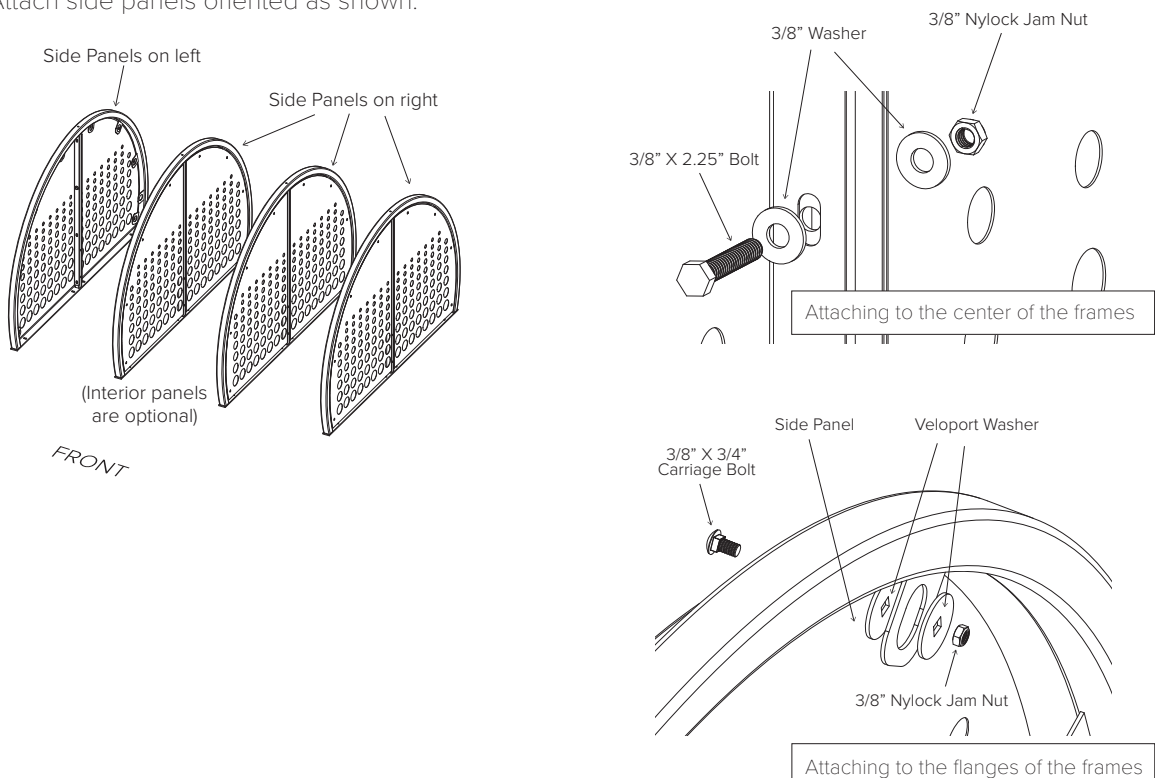

Installation Instructions

3 Attach initial left door frame.

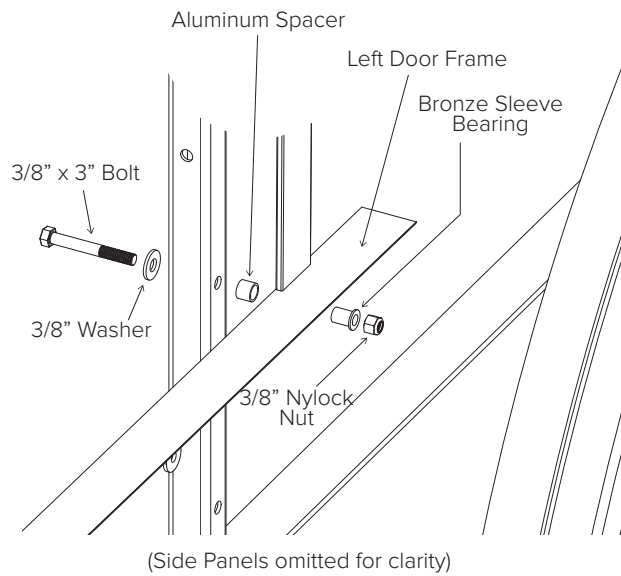
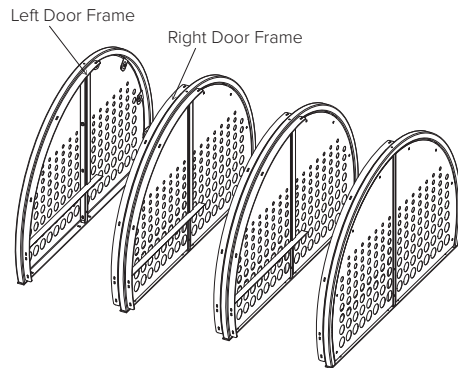

4 Attach right and left door frames.

Attach last right door frame similarly to step 3.

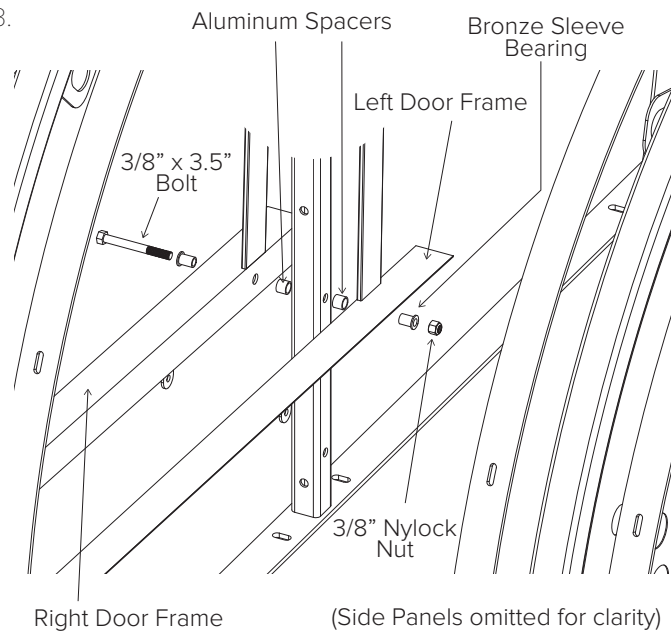

Installation Instructions

5

Attach door panels to the door frames. The (4) corners of the door panel are attached with a 5/16" x 1.75" carriage bolt and also receive a door wheel. The rest of the carriage bolts are 5/16" x 1". Confirm that the door assembly is aligned before tightening bolts.

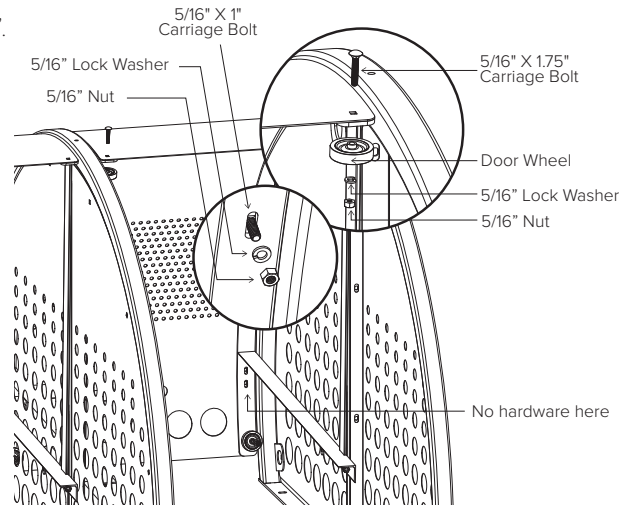
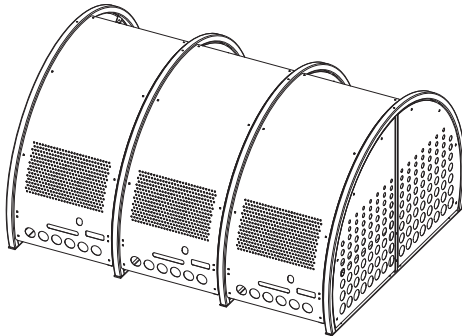

6

Attach the handle assembly to the door. Some vertical adjustment is available to align the lock bar with the strike. A small 1/4" drive socket wrench or ratcheting wrench works best.

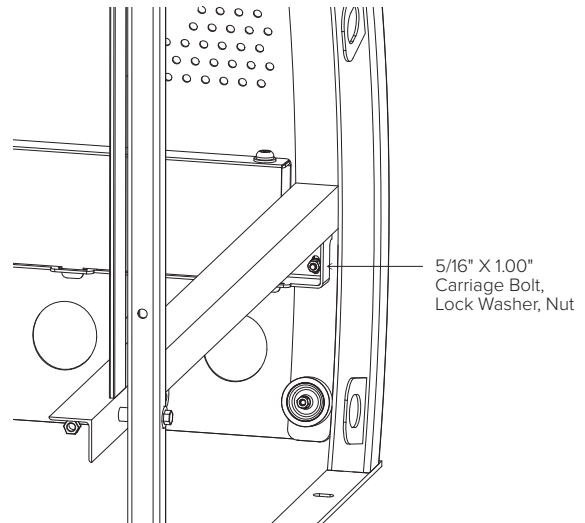
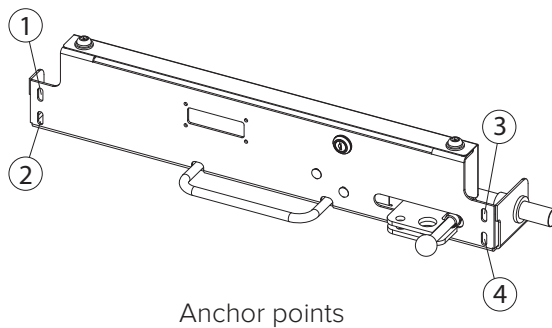

Installation Instructions

7

Attach the initial left door damper.

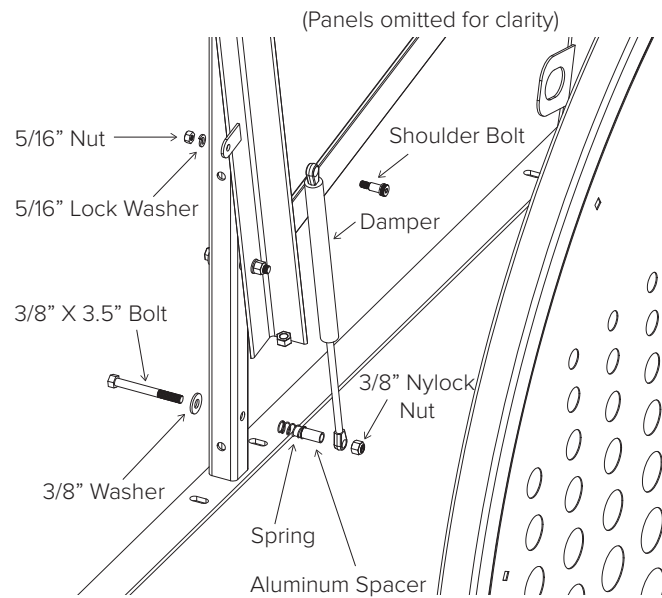
**8**

Attach right and left door dampers.

Attach last right door damper similarly to step 7.

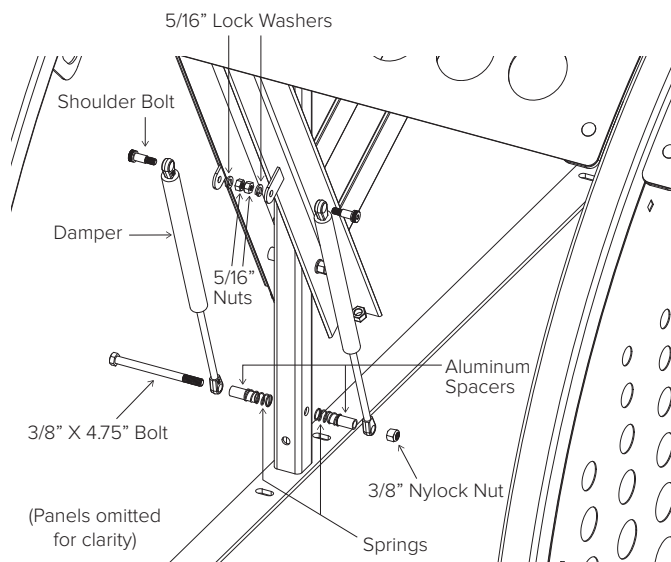

Installation Instructions

9

Attach the spring through the flange hole and the nut welded to the door frame.

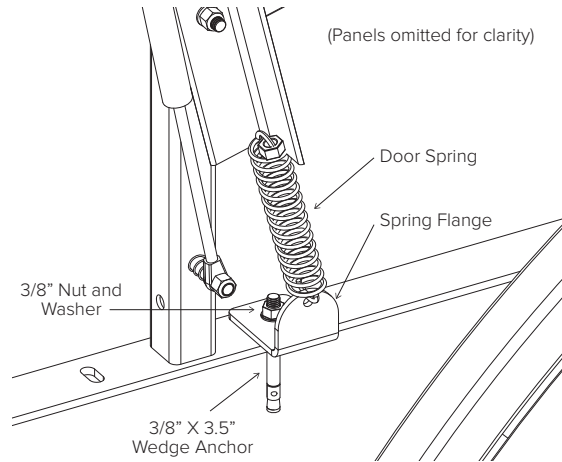
**10**

Attach the right and left springs to the flange holes and the nuts welded to the door frames.

Attach the last right spring to the flange hole and the nut welded to the door frame.

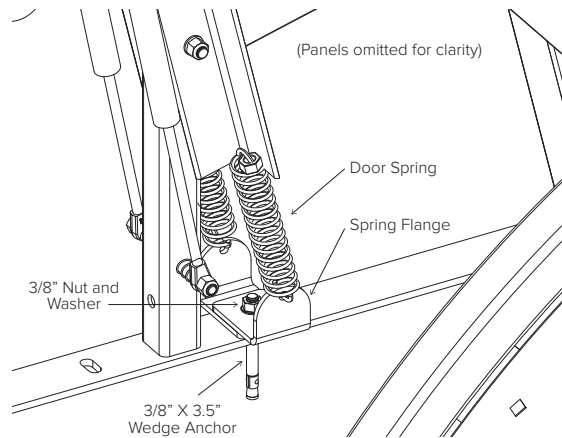

Installation Instructions

11

After confirming that the doors open and close smoothly, and that the top of the frames are at 32" on-center, attach the rear panels.

Attach the rest of the rear panels with the subsequent panels overlapping the previous.

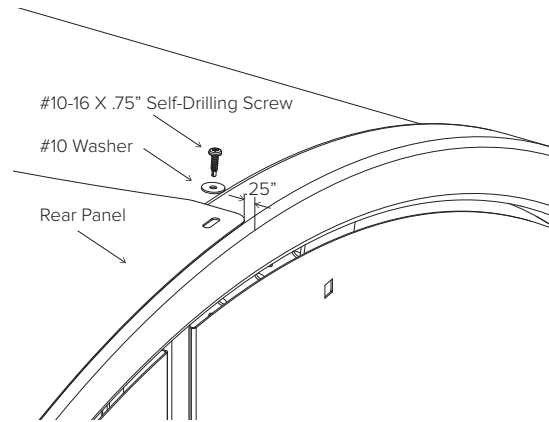
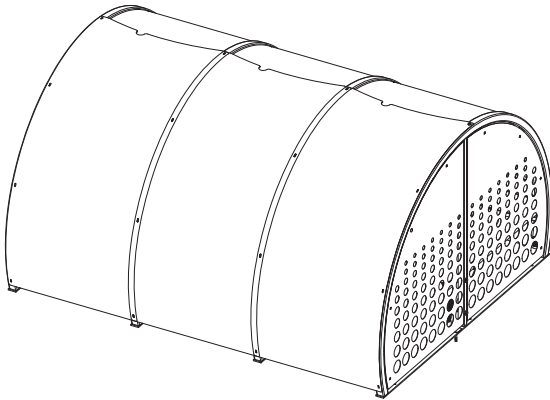

12

Tighten all frame base anchors.

Confirm all doors still open and close smoothly and that lock bars engage the lock strike.

13

Anchor the bike tray to the ground centered between frames (16" on center between frames and bike trays).

