

METER HITCH



Parking for Bikes, Too!

Based on our popular Bike Hitch, the Meter Hitch is designed to fit into the streetscape. The Meter Hitch has a minimal footprint and is a bicyclist favorite for its ease of use and solid bike support. Planners also appreciate that design restricts bikes to parking parallel with the rack so bikes will not interfere with pedestrian right of way or the street. *Patent D620,8455*

PRODUCT & PRICING INFO CONTACT

 **STREETSCAPES**
STREETSCAPES.BIZ

Info@streetscapefurniture.com ■ 303.398.7040

METER HITCH



FINISH OPTIONS

Galvanized



Stainless



Powder Coat

White	Black	Light Gray RAL 7042	Deep Red RAL 3003	Yellow RAL 1023
CNH Bright Yellow	Orange RAL 2004	Blue RAL 5005	Sky Blue RAL 5015	Hunter Green RAL 6005
Light Green RAL 6018	Green RAL 6016	Sepia Brown RAL 8014	Bronze	Silver 9007
Dark Purple	Flat Black	Wine Red RAL 3005	Beige RAL 1001	Iron Gray 7011

METER HITCH

Submittal Sheet

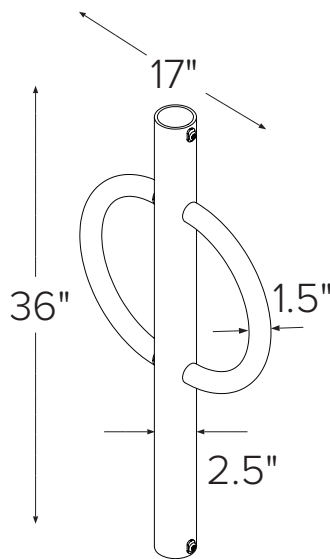

CAPACITY 2 Bikes

MATERIALS Centerbeam: 2.5" schedule 40 pipe

All Meter Hitches are made based on existing pole dimension. Please verify all post dimensions with Dero before ordering.

FINISHES

☐ **Galvanized**
An after fabrication hot dipped galvanized finish is our standard option.

☐ **Powder Coat**
Our powder coat finish assures a high level of adhesion and durability by following these steps:
1. Sandblast
2. Epoxy primer electrostatically applied
3. Final thick TGIC polyester powder coat

☐ **Stainless**
Stainless Steel: 304 grade stainless steel material finished in either a high polished shine or a satin finish.

MOUNT OPTIONS

Hitch Mount
Meter Hitch slides over existing 2.38" OD parking meter poles. Two tamper-resistant set screws secure the Meter Hitch to the parking meter pole.

METER HITCH

Installation Instructions

