

1 SIDE ELEVATION VIEW

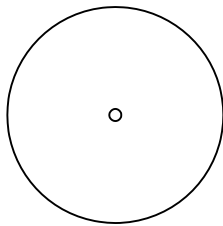

2 TOP VIEW

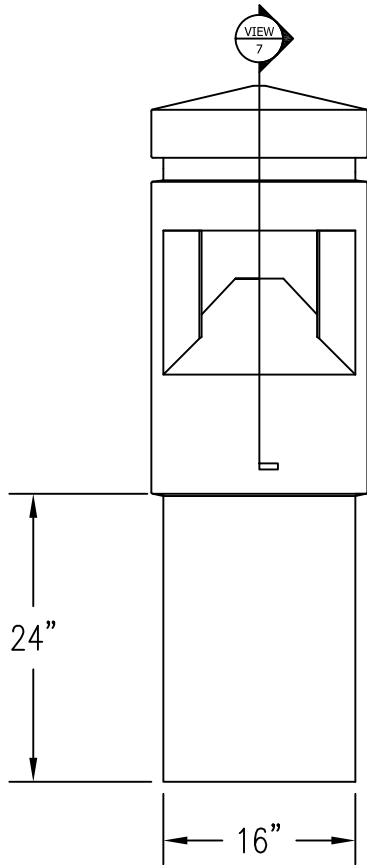

3 FRONT ELEVATION VIEW

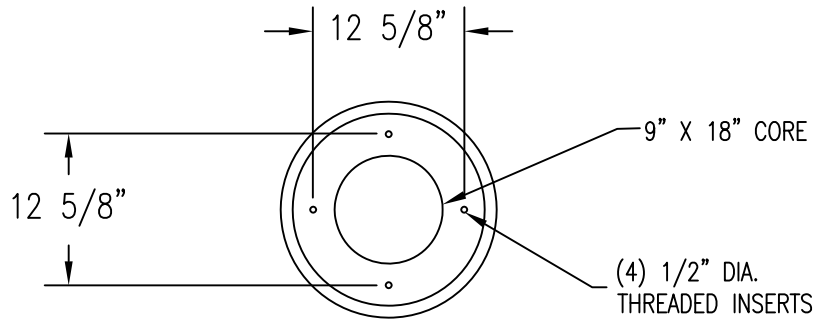

4 BOTTOM VIEW

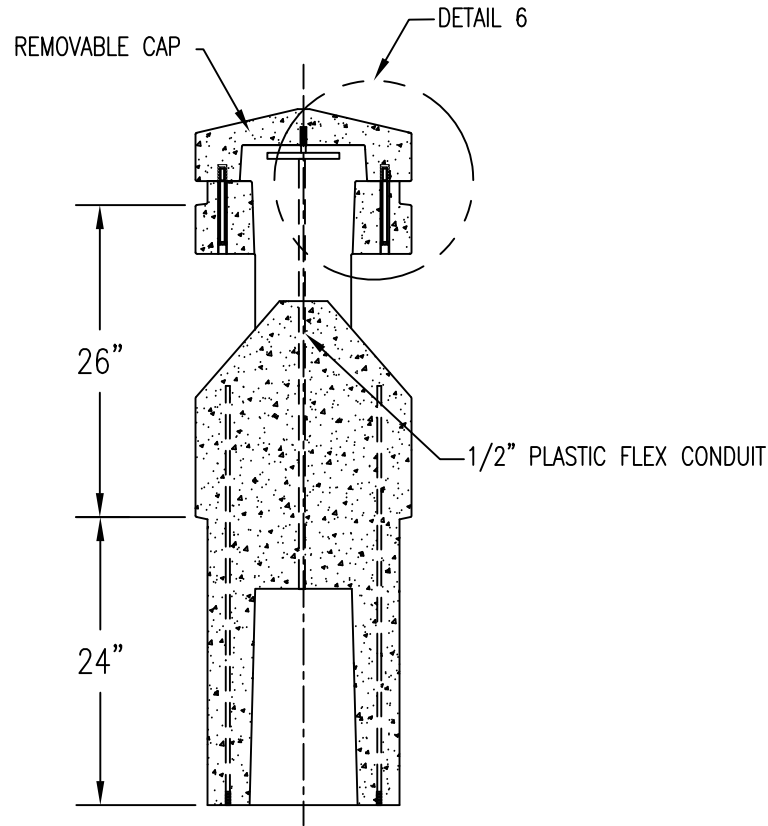

5 CROSS SECTION

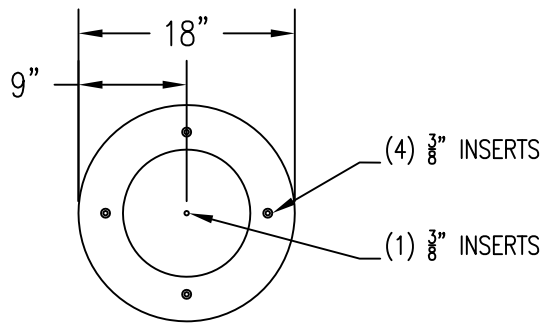

8 BOTTOM VIEW OF CAP

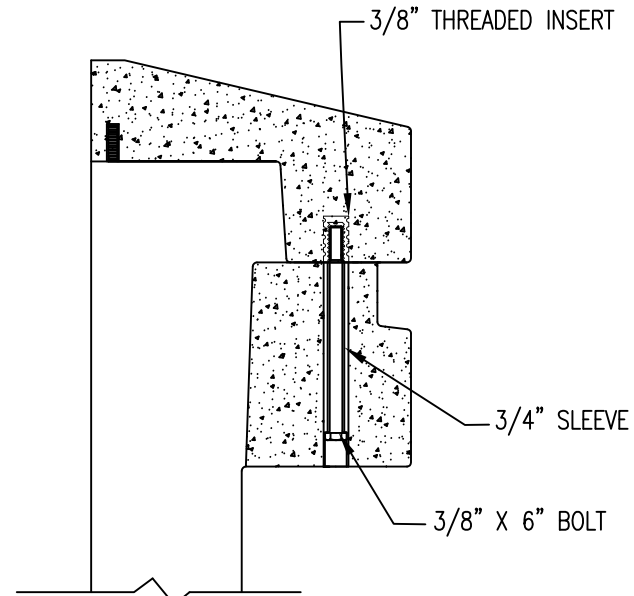

6 DETAIL

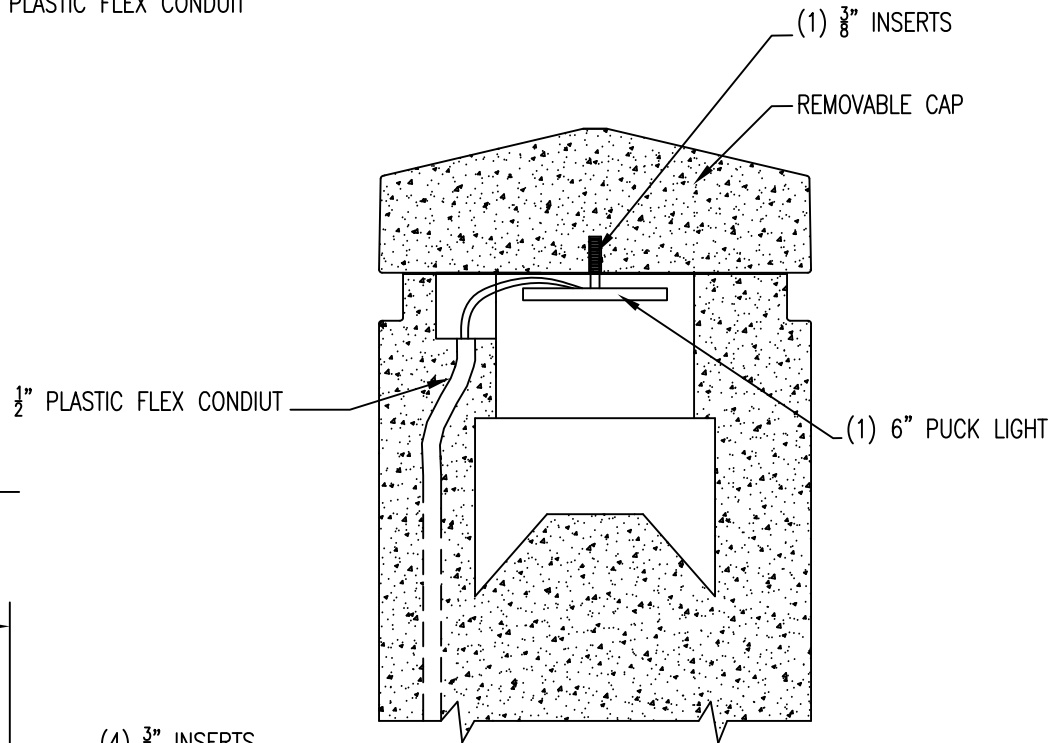

7 SECTION

REVISIONS		
NAME	DATE	NOTES
1	---	---
2	---	---
3	---	---
4	---	---
5	---	---
6	---	---
7	---	---
8	---	---

CONFIDENTIAL INFORMATION
THESE DRAWING, SPECIFICATIONS AND
OTHER INFORMATION AND DOCUMENTS
ACCOMPANYING THEM ARE THE
CONFIDENTIAL AND PROPRIETARY PROPERTY
OF WAUSAU TILE, INC. THE DRAWINGS
THEMSELVES SHALL BELONG TO THE
OWNER FOR USE ONLY ON THE PROJECT.
ANY ADDITIONAL USE SHALL REQUIRE THE
PRIOR WRITTEN APPROVAL OF WAUSAU
TILE, INC. THE PROPRIETARY INFORMATION
CONTAINED WITHIN THE DRAWINGS AND
THE DOCUMENTS IS AND SHALL REMAIN
THE SOLE PROPERTY OF WAUSAU TILE, INC.

JOB NAME

ADDRESS
CITY, STATE ZIP

UNLESS OTHERWISE SPECIFIED
DIMENSIONS ARE IN INCHES
FRACTIONS ±1/8"

DRAWN BY: SK

DATE: 6/19/15

CO NUMBER: ?

WEIGHT: 850 LBS

PRODUCT NO.

TF 6050

SPHERE BOLLARD ANCHOR
24" - 30" - 36"

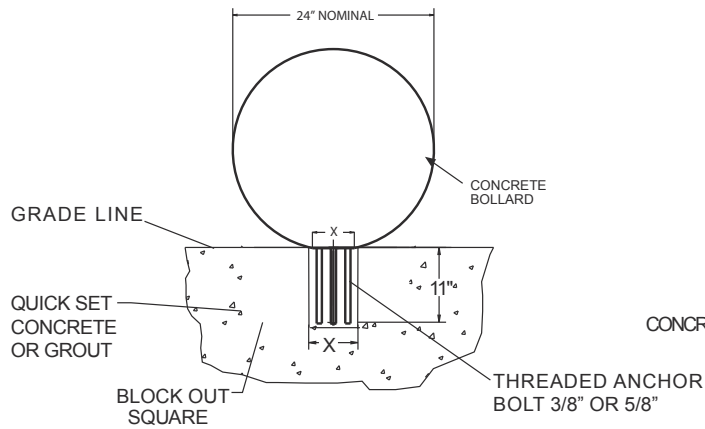

X = BLOCKOUT DIMENSION SHOULD BE 1/2" LESS THAN THE OUTSIDE OF THE SURFACE AREA TOUCHING THE GROUND.

ANCHOR STYLE C

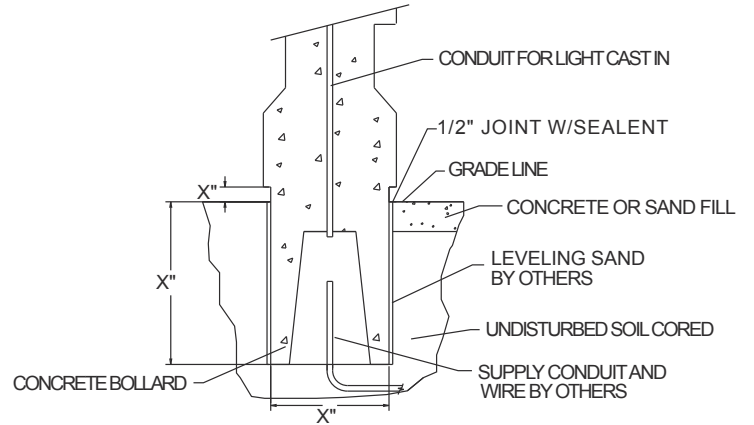

SPHERE BOLLARD ANCHOR
12" - 18"

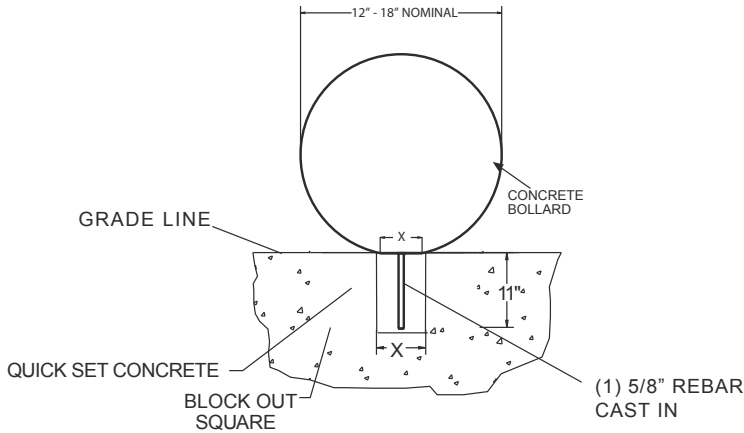

ANCHOR STYLE A

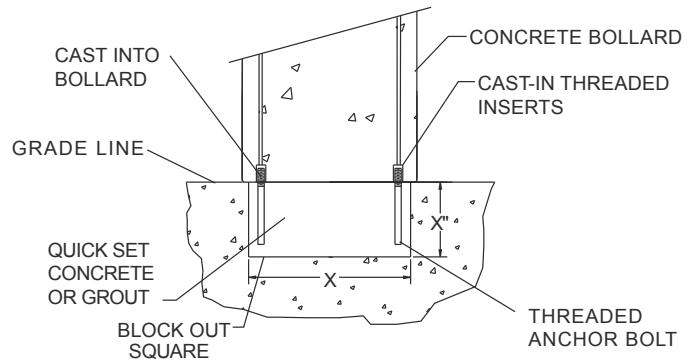

NOTE: THIS TYPE ANCHORING IS NOT USED AS BARRICADE. IF USING BOLLARD WITH LIGHT, RUN CONDUIT THROUGH CENTER OF BOLT PATTERN AND STUB OUT.

X = BLOCKOUT DIMENSION SHOULD BE 1/2" LESS THAN THE OUTSIDE OF THE BOLLARD.

ANCHOR STYLE B

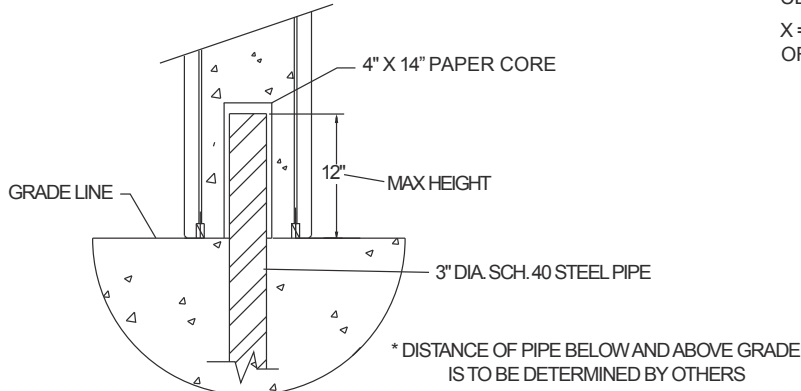

NOTE: THIS TYPE ANCHORING IS ALSO USED AS A BARRICADE. BOLLARD HELD IN PLACE BY STEEL PIPE. STEEL PIPE MUST BE ANCHORED IN CONCRETE FOOTING.

TYP. 12" DIA. CONCRETE BOLLARD SAME. ANCHORING SYSTEM USED ON 14" AND 18" DIA. OR SQ. BOLLARDS.